

Tecofi'Φ

VALVE DESIGNER - FRANCE

Tecofi valves adapted to your manufacturing process:

- ✓ Paper pulp processing
- ✓ Bleaching process
- ✓ Pulper exit
- ✓ Water supply
- ✓ Waste water treatment

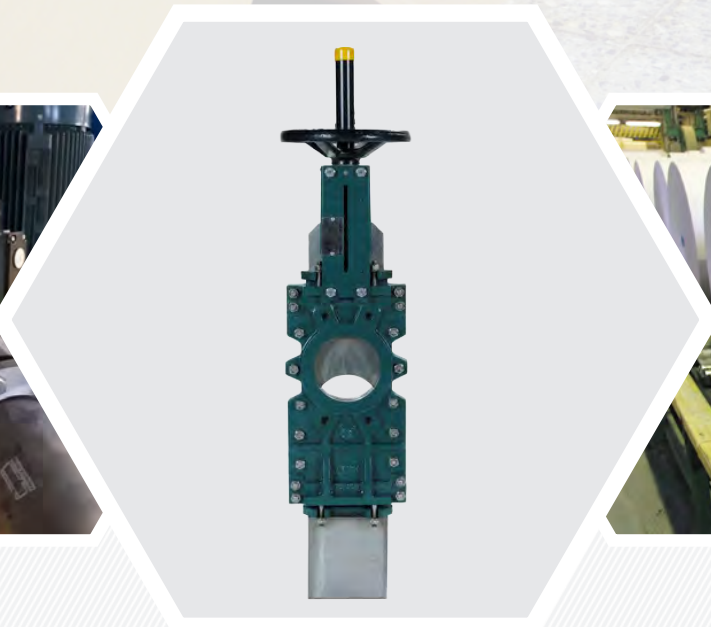

OUR SOLUTIONS
FOR PAPER INDUSTRY

Valve Specialist





PAPER INDUSTRY

OUR TECHNICAL SOLUTIONS

The profitability of a paper mill is based on volume, each factory stop resulting in dead loss. The quality and durability of installed equipment has to be at the center of your mind. Our products ensure reliability, eased maintenance, and performance, providing you with productivity and responding to all of your technical demands for the manufacturing process.

In Stock
Quick delivery*

VG STANDARD EN-GJL-250 CAST IRON BODY

VG3400-00
DN 50 to DN 600

VG3400-UX4
DN 50 to DN 1200

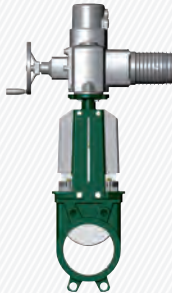

VG3400-08
DN 700 to DN 1200

VG3400-03
DN 50 to DN 1200

All models are available with ANSI 150 connection

- ✓ Knife gate valve with handwheel, gearbox, double-acting actuator or electric actuator with protection plates
- ✓ Ductile iron GGG40 bolted packing gland Can be tighten and during use (Nylstop® nuts)
- ✓ Resistant one-piece body in cast iron EN-GJL-250 Range will be soon upgraded in ductile iron EN-GJS-500-7
- ✓ Anti-abrasion Flucast® type seal (option), heel-shaped moulded elastomer, providing perfect unidirectional tightness (EPDM/NBR/FPM)
- ✓ Available in metal to metal seat for use with abrasive fluids
- ✓ Small retention area allowing complete gate closure

VG STAINLESS STEEL 316 (CF8M) BODY

- ✓ Adapted for harsh environments
- ✓ Stainless steel 316 bolted packing gland. Can be tighten during use (Nylstop® nuts)
- ✓ **One-piece cast body in stainless steel 316 (CF8M), resistant to corrosion and to shocks during cyclonic purification**
- ✓ Full bore when fully opened, allowing a large flow with low head loss

VG6400-00
DN 50 to DN 600

VG6400-UX4
DN 50 to DN 1200



VG6400-08
DN 700 to DN 1200

VG6400-03
DN 50 to DN 1200

VG THROUGH CONDUIT



VGT3400-00
DN 50 to DN 400

Available with
stainless steel body
VGT6400



VGT3400-03
DN 50 to DN 400



- ✓ **Ideal at pulper exits**
- ✓ Through conduit knife gate valve with handwheel or double-acting pneumatic actuator
- ✓ Long, sturdy body made of two bolted parts
- ✓ Bi-directional tightness ensured by two seat gaskets (metal to metal version on request)
- ✓ Easy actuation in difficult conditions
- ✓ Without retention area, application on line for thick paste

*for standard models

TAILOR-MADE SOLUTIONS FOR YOUR VALVES AND INCREASE OF PERFORMANCE!

✓ Simplified use and maintenance

POSITION INDICATOR

Rising-stem knife gate valve, on-off or regulation (non-rising stem option in stock).

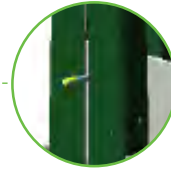

STAINLESS STEEL 316 DEFLECTORS

Flow regulation for thick or abrasive fluids. Protection of seat from wear.

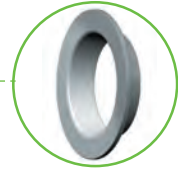

STAINLESS STEEL 304 SCRAPER

Kit installed at packing gland level.
Removes particles stuck to both sides of the gate.

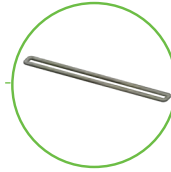

INDUCTIVE OR MECHANICAL LIMIT SWITCHES

Allow your process automation.



ADJUSTABLE MECHANICAL STOPS

Mechanically limit the opening and closing.



✓ Valve certified Machinery Directive 2006/42/EC without risk of injury

STAINLESS STEEL SUPPORT AND PROTECTION

Standard pre-shaped and pre-drilled for mounting ASCO limit switches and solenoid valves. Secure the valves and protect the limit switches.
Simplified accessory mounting from DN 50 to 300.

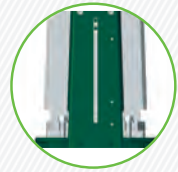

STANDARD STAINLESS STEEL HOODS

Protect limit switches from potential pulp projection. Avoid any defect requiring maintenance work.



LOCKOUT SYSTEM

Secure your network and your technicians during checks.
Ensure continuous production.



CHAINWHEEL ASSEMBLY

Ease of operating valves in high positions.



PROTECTIVE STEM SLEEVE

✓ Enhanced resistance against abrasion and corrosion

STAINLESS STEEL 304 CUTTING GATE / (316L OPTION)

Machined and polished for closure without blockage.

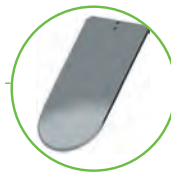

MIRROR-POLISHED GATE (OPTION)

Decrease friction coefficient and prevent products from sticking.



HARDENED GATE (OPTION)

Core treatment HARDOX® or superduplex steel to reinforce the gate durability.
Increase the equipment's lifespan.
Shock resistant at cyclonic separator exit.
Abrasion resistance.

Our design and research team is here for you to study your needs and constraints, adapting pieces and instruments to your specific orders.
ATEX on request.

Reduce your maintenance costs!

Find all of our products and datasheets on our website

www.tecofi.fr

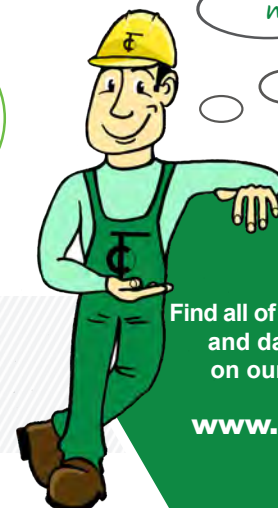



Tecofi'Φ

VALVE DESIGNER - FRANCE

TECOFI - FRANCE
Headquarters
83 rue Marcel Mérieux
69960 Corbas - France

Offices
ZAC Everest Parc
8 rue Joseph Nicéphore Niépce
69740 Genas

T. +33 (0)4 72 79 05 79
F. +33 (0)4 78 90 19 19
✉ sales@tecofi.fr

 WhatsApp Chat
+33 623 898 706
www.tecofi.fr