

Ref. : RC 4240.pas

Rev. : E

Date : 26/01/2015

Page : 1/1

FLANGED BALANCING VALVE PN16

RC 4240



Tecofi'
VALVE DESIGNER - FRANCE

APPLICATION

Accurate adjustment or stop valve on big heating and cooling systems, in new jobs or maintenance.

GENERAL CHARACTERISTICS

From DN65 to DN300.
Design according to BS7350:1990.
Oblique seat which allows a good adjustment precision.
Position indicator with a stroke limiter.
Fast draining and padding thanks to the drain plug.
Handwheel operating.

CONSTRUCTION

21	1	Packing gland	Brass (DN65-DN150) Ductile iron GGG50 (DN200-300)	EN12165 CW602N EN-JS1050
20	1	Indicator dust cover	ABS	
19	4-12	Spring gasket	Stainless steel	BS970 304S15
18	4-12	Bolt	Stainless steel	BS970 304S15
17	2	Hexagon socket screws	Stainless steel	BS970 304S15
16	1	Big gasket	Stainless steel	BS970 304S15
15	1	Bolt	Stainless steel	BS970 304S15
14	2	Plug	Steel	
13	1	Hand wheel	Ductile iron GGG50	EN-JS1050
12	2	Packing	EPDM	
11	1	Indicator	ABS	
10	1	Directed circle	ABS	
9	1	Oriented set of indicator	Brass	EN 12165 CW602N
8	2	Limit set of indicator	Stainless steel	BS970 304S15
7	1	Stem lock bushing	Brass	EN 12165 CW602N
6	1	Cover	Ductile iron GGG50	EN-JS1050
5	1	Stem	Stainless steel	BS970 410S21
4	1	Stem nut	Brass	EN 12165 CW602N
3	1	Disc	Ductile iron GGG50 + EPDM	EN-JS1050
2	1	Seal gasket	EPDM	
1	1	Body	Ductile iron GGG50	EN-JS1050
Pos.	Q-ty	Description	Material	

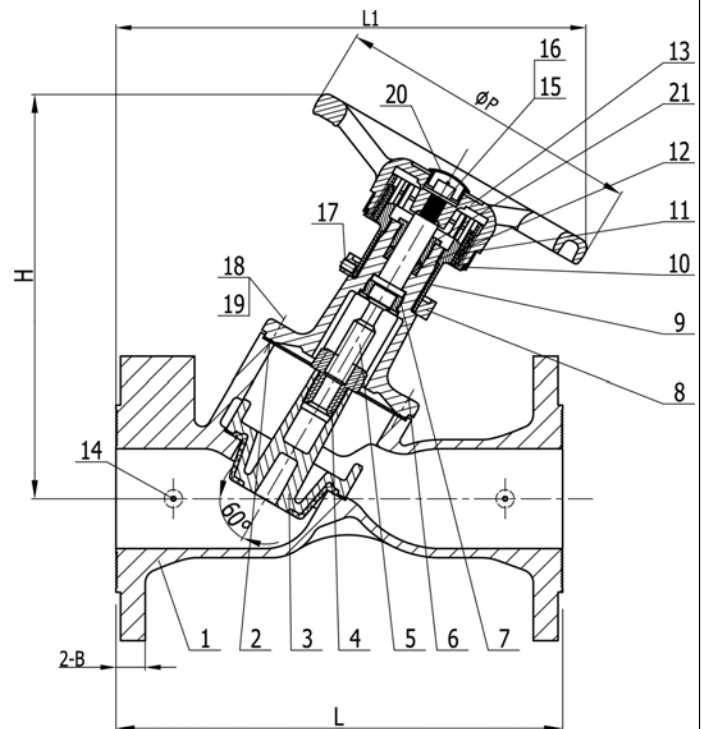

DIMENSIONS

DN		H	L	L1	B	ØP	Weight (kg)
mm	inch						
65	2" 1/2	265	290	310	19	200	17
80	3"	370	310	320	19	200	20
100	4"	310	350	360	19	240	29
125	5"	340	400	415	19	290	40
150	6"	350	480	445	19	290	52
200	8"	537	600	620	20	350	113
250	10"	591	730	720	22	420	185
300	12"	690	850	875	24.5	420	248

WORKING CONDITIONS

Maximum working pressure : 16 bar
Maximum working temperature : -10°C / 120°C

STANDARDS

Flange connection according to EN 1092-2 ISO PN 16.
Test pressure according to EN 12266-1, DIN 3230,
BS 6755 and ISO 5208.

TECOFI France - 83, Rue Marcel Mérieux 69960 Corbas - FRANCE
Tél. +33 (0) 4 72 79 05 79 - Fax +33 (0) 4 78 90 19 19 / +33 (0) 4 72 79 05 70
Adresses e-mail : sales@tecofi.fr ; tecofi@tecofi.fr / Site web : www.tecofi.fr