

GLOBE VALVE

TECHNICAL PASSPORT

FLANGED PN16 GLOBE VALVE CAST IRON BODY

R3240

APPLICATION

The globe valve is indicated for ON/OFF and regulating operations in liquid and gas transfer circuits.

- **Area of use:** water networks, industry, thermal installations.



Fluids : non-corrosive and non-toxic fluids, steam, high temperatures.

GENERAL CHARACTERISTICS

Range : from DN15 to DN300.

- Flanged PN16 globe valve.
- Simple and robust construction
- Sealing by graphite gland packing and graphite gasket.
- Bolted bonnet and stuffing box facilitating maintenance operations
- Mounting direction indicated by an arrow on the body

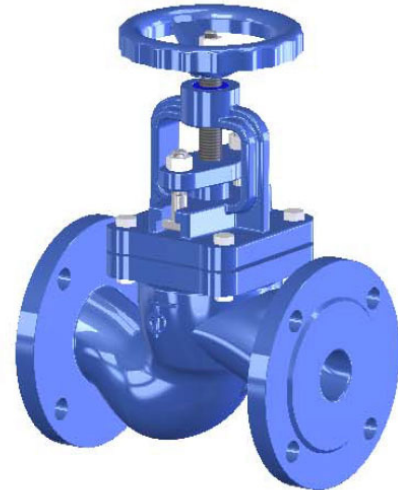

STANDARDS

Face to face	Face to face according to standards NF EN 558-1, DIN 3202 / F1.
Connection	Flanges drilled according to standard EN 1092-2 and DIN 2501 : ISO PN16.
Tests	Pressure test according to standards EN12266-1, DIN 3230 and ISO 5208: -Body : PS x 1.5 bar -Seat : PS x 1.1 bar

PRODUCT APPROVALS



Tecofi France

83 rue Marcel Mérieux - 69960 Corbas
Tél. +33 (0)4 72 79 05 79 - Fax. +33 (0)4 78 90 19 19
E-mail : sales@tecofi.fr - www.tecofi.fr

ISO 9001
ISO 14001
BUREAU VERITAS
Certification



GLOBE VALVE

TECHNICAL PASSPORT

R3240

CONSTRUCTION

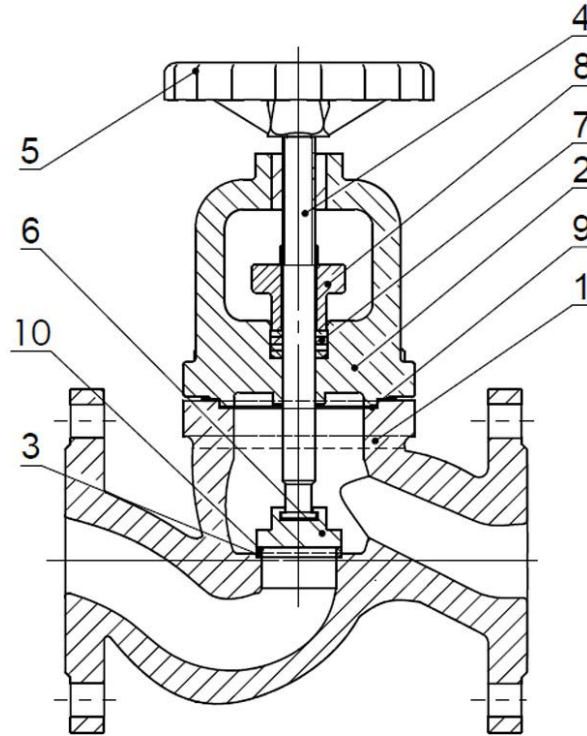

Pos.	Q-ty	Description	Material	Equivalences		
				DIN	ASTM	BS
1	1	Body	Cast iron EN-GJL-250	GG25	A48 class 40B	1452 Grade 250
2	1	Bonnet	Cast iron EN-GJL-250	GG25	A48 class 40B	1452 Grade 250
3	1	Seat	Stainless steel X20Cr13	X20Cr13	AISI420	1.4021
4	1	Stem	Stainless steel X5CrNi 18-10	X5CrNi 18 10	A 182 AISI 304	1449-2 304 S15
5	1	Handwheel	Cast iron EN-GJL-250	GG25	A48 class 40B	1452 Grade 250
6	1	Disc	Cast iron EN-GJL-250	GG25	A48 class 40B	1452 Grade 250
7	1	Packing	Graphite			
8	1	Gland follower	Ductile iron EN-GJS-450-10	EN 1563/A1	A536-65-45-12	2789 450/10
9	1	Bonnet gasket	Graphite			
10	1	Disc seat	Stainless steel X20Cr13	X20Cr13	AISI420	1.4021

The photographs and technical art works are not contractual. The specifications of the presented products are open to modifications without previous advice.

Tecofi France

83 rue Marcel Mérieux - 69960 Corbas
 Tél. +33 (0)4 72 79 05 79 - Fax. +33 (0)4 78 90 19 19
 E-mail : sales@tecofi.fr - www.tecofi.fr



GLOBE VALVE

TECHNICAL PASSPORT

R3240

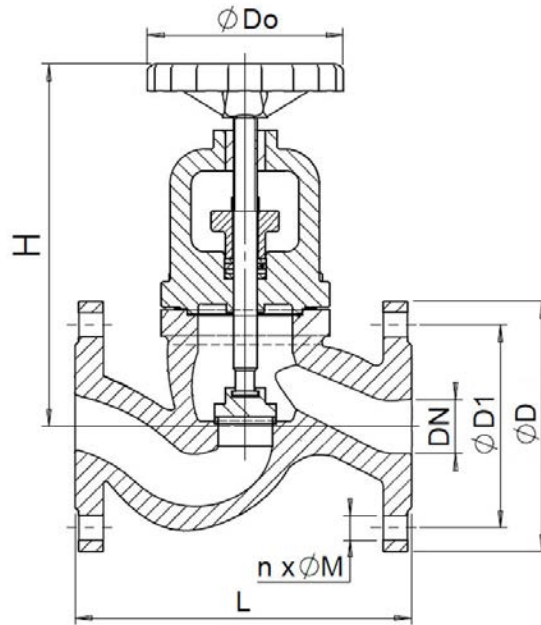

DN		L	øD	øD1	øD0	H	nx øM	Weight (kg)
mm	inch							
15	1/2"	130	95	65	100	161.5	4x14	3
20	3/4"	150	105	75	100	169	4x14	4
25	1"	160	115	85	120	187	4x14	5.5
32	1"1/4	180	140	100	120	223	4x19	8
40	1"1/2	200	150	110	140	233.5	4x19	11
50	2"	230	165	125	140	261.5	4x19	14.7
65	2"1/2	290	185	145	200	293	4x19	17.8
80	3"	310	200	160	200	341	8x19	26.7
100	4"	350	220	180	240	381	8x19	35.4
125	5"	400	250	210	280	419	8x19	59
150	6"	480	285	240	315	485	8x23	78
200	8"	600	340	295	360	569	12x23	136
250	10"	730	405	355	400	634	12x28	212.5
300	12"	850	460	410	400	801	12x28	321

The photographs and technical art works are not contractual. The specifications of the presented products are open to modifications without previous advice.

Tecofi France

83 rue Marcel Mérieux - 69960 Corbas
 Tél. +33 (0)4 72 79 05 79 - Fax. +33 (0)4 78 90 19 19
 E-mail : sales@tecofi.fr - www.tecofi.fr

ISO 9001
 ISO 14001
 BUREAU VERITAS
 Certification



GLOBE VALVE

TECHNICAL PASSPORT

R3240

HEAD LOSS DIAGRAM

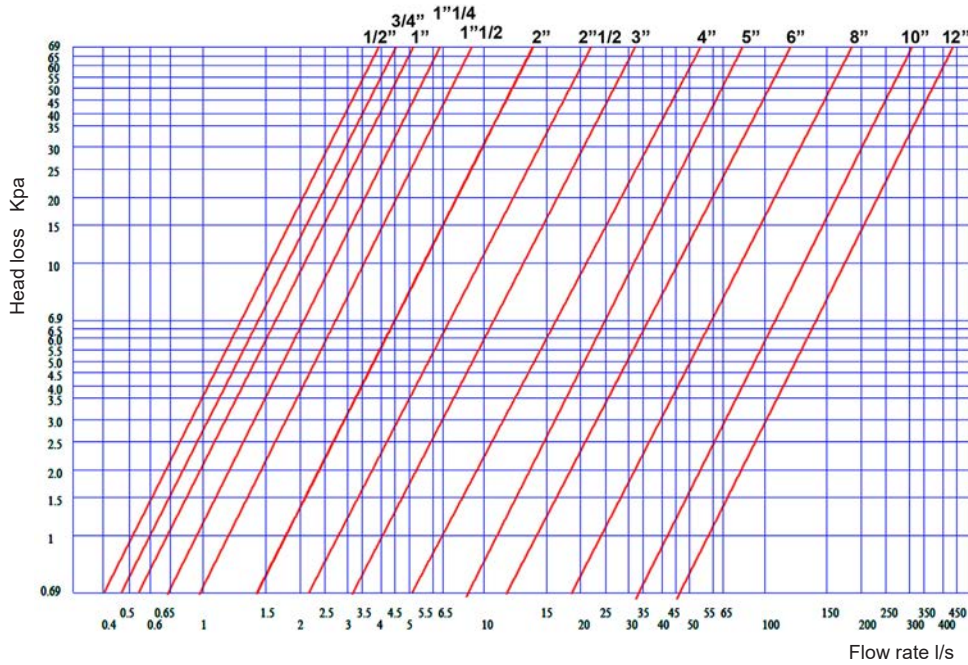

WORKING CONDITIONS

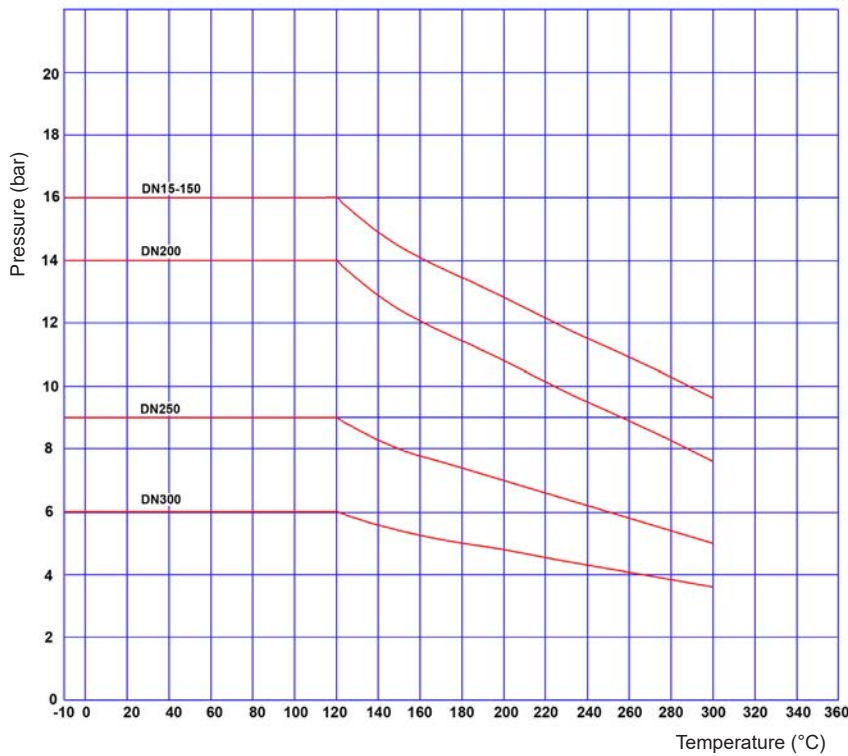

Limited use for steam : 10 bar and 184°C

Tecofi France

83 rue Marcel Mérieux - 69960 Corbas
 Tél. +33 (0)4 72 79 05 79 - Fax. +33 (0)4 78 90 19 19
 E-mail : sales@tecofi.fr - www.tecofi.fr

