

Ref. : MA 6105.pas

Rev. : Initial

Date : 04/10/2016

Page : 1/1

# STAINLESS STEEL PRESSURE GAUGE WITH CONTACT

## MA 6105



**Tecofi'**  
VALVE DESIGNER - FRANCE

### APPLICATION

Control on compressors, presses, hydraulic and pneumatic equipments, chemical and petrochemical plants.

### GENERAL CHARACTERISTICS

Stainless steel pressure gauge fitted with a contact for opening or closing the circuit depending on the position of the indicating needle.

silicone filled model, 6 wires and cable gland for 7.13 mm cables.

Scale: from 0.6 to 1.6 bar.

Accuracy: 1.0% according to UNI 8293 - DIN16085.

Protection: IP55 according to EN16085.

BSP connection.

### CONSTRUCTION

Needle	Black aluminium
Manometric tube	Stainless steel
Dial	Aluminium
Glasse	Plastic
Connection	Stainless steel
Housing	Stainless steel
Description	Material

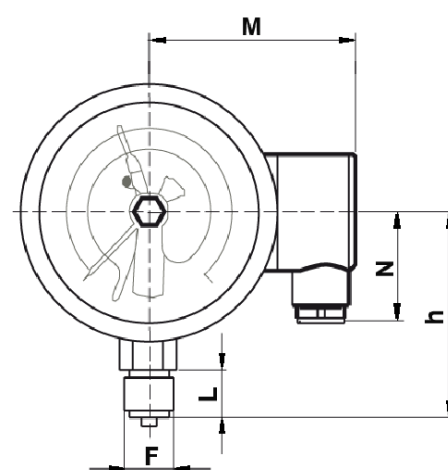
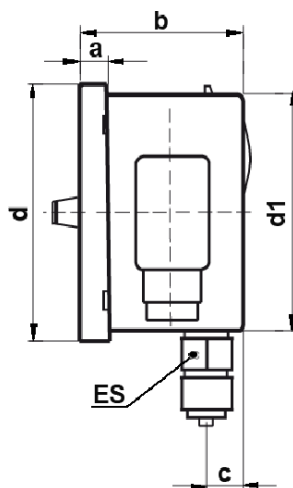

### DIMENSIONS

F	a	b	c	d	d <sub>1</sub>	h	M	N	L	Weight (kg)
1/2	13	71.5	16.1	110.6	101	88.5	93	46	20	1.05

### WORKING CONDITIONS

Maximum temperature : +100°C.

Ambiente temperature: -25°C / +65°C

### STANDARDS

Complies the requirements of standard

BT 73/23/CEE - PED 97/23/CE.

Threaded connection BSP according to UNI ISO 228.



The photographs and technical art works are open to modifications without previous advice.