

Ref. : JT4242 .pas

Rev. : A

Date : 23/01/2015

Page : 1/1

DISMANTLING JOINTS PN16

JT4242



Tecofi
VALVE DESIGNER - FRANCE

APPLICATION

General use : for easy installation and dismantling of valves.

GENERAL CHARACTERISTICS

Range : from DN 80 up to DN 2600.
Rigid connection between the connecting pipes.
Long course.
PN16.



CONSTRUCTION

6	-	Nut	Zinc plated steel	
5	-	Stud bolt	Zinc plated steel	
4	1	Sealing ring	EPDM	
3	1	Retaining flange	Ductile iron EN-GJS-500-7	DIN: GGG50 ASTM: A536 70-50-05 BS: 500/7
2	1	Flanged pipe - long	Ductile iron EN-GJS-500-7	DIN: GGG50 ASTM: A536 70-50-05 BS: 500/7
1	1	Flanged pipe - short	Ductile iron EN-GJS-500-7	DIN: GGG50 ASTM: A536 70-50-05 BS: 500/7
Pos.	Qty.	Description	Material	

DIMENSIONS

DN		D2	D4	D5	L1	L2	d	N	t
mm	inch								
80	3"	98	160	200	200	310	16	8	7,0
100	4"	118	180	220	200	310	16	8	7,2
125	5"	144	210	250	200	310	16	8	7,5
150	6"	170	240	285	200	320	20	8	7,8
200	8"	222	295	340	220	340	20	12	8,4
250	10"	274	355	400	230	370	24	12	9,0
300	12"	326	410	455	250	410	24	12	9,6
350	14"	378	470	520	260	410	24	16	10,2
400	16"	429	525	580	270	430	27	16	10,8
450	18"	480	585	640	270	430	27	20	11,4
500	20"	532	650	715	280	440	30	20	12,0
600	24"	635	770	840	300	480	33	20	13,2
700	28"	738	840	910	300	480	33	24	14,4
800	32"	842	950	1025	320	520	36	24	15,6
900	36"	945	1050	1125	320	520	36	28	16,8
1000	40"	1048	1170	1255	340	560	39	28	18,0
1100	44"	1152	1270	1355	340	560	39	32	19,2
1200	48"	1255	1390	1485	360	600	45	32	20,4
1400	56"	1462	1590	1685	380	630	45	36	22,8
1500	60"	1565	1710	1820	400	665	52	36	23,0
1600	64"	1668	1820	1930	400	700	52	40	25,2
1800	72"	1875	2020	2130	420	730	52	44	27,6
2000	80"	2082	2230	2345	440	730	56	48	30,0
2200	88"	2288	2440	2555	450	750	56	52	32,4
2400	96"	2495	2650	2765	460	770	56	56	34,8
2600	104"	2702	2850	2965	500	800	56	60	37

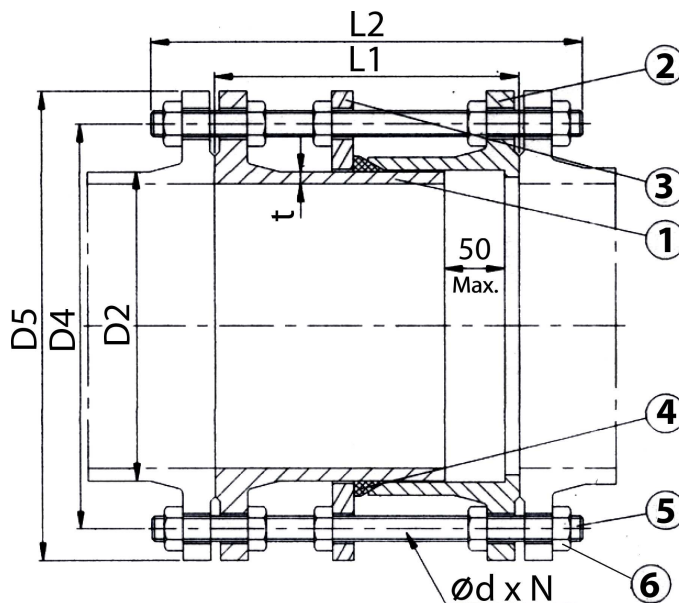

STANDARDS

Flanges in accordance with ISO 2531 PN16