

RUBBER EXPANSION JOINT

TECHNICAL PASSPORT

RUBBER EXPANSION JOINT WITH STAINLESS STEEL SWIVEL FLANGE

DI7242-EP

APPLICATION

- Reduction of mechanical and thermal stress on pipes and related systems : pumps, compressors, motors.
- Absorption of vibrations and noise
- Compensation of axial, lateral and angular movements
- Correction of misalignment of the piping.



Fluids : hot and cold water

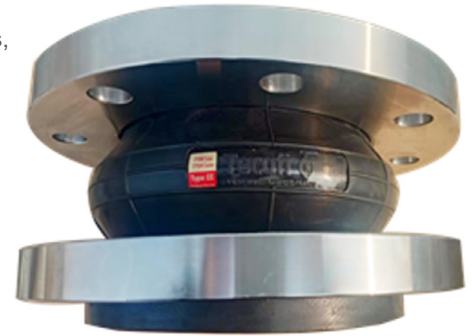

GENERAL CHARACTERISTICS

- Range : from DN32 to DN600.
- Universal expansion joint consisting of :
- EPDM elastomer bellows
 - Swivel flanges made of stainless steel.

CONSTRUCTION

Pos.	Quantity	Description	Material
1	2	Flange	Stainless steel
2	2	External bellow	EPDM
3	1	Reinforcement	Nylon tyre cord
4	1	Internal bellow	EPDM
5	1	Reinforcement wire	Acier

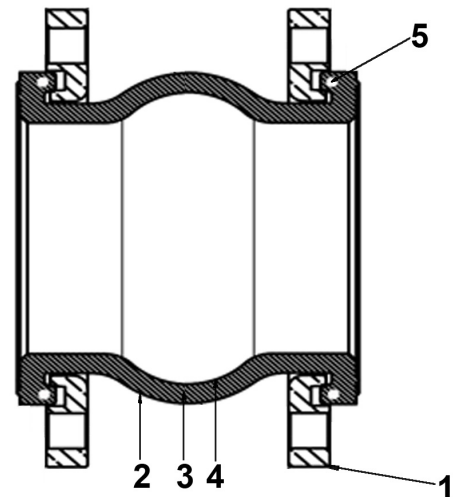

STANDARDS

Connection	Flange connection according to standard EN 1092-1 : PN10/16 from DN32 to DN150 PN16 from DN200 to DN600.
Test	Pressure test according to standards EN12266-1, DIN 3230 and ISO 5208 :

PRODUCT APPROVALS



Tecofi France

83 rue Marcel Mérieux - 69960 Corbas
Tél. +33 (0)4 72 79 05 79 - Fax. +33 (0)4 78 90 19 19
E-mail : sales@tecofi.fr - www.tecofi.fr



RUBBER EXPANSION JOINT

TECHNICAL PASSPORT

RUBBER EXPANSION JOINT WITH STAINLESS STEEL SWIVEL FLANGE

D17242-EP

DIMENSIONS

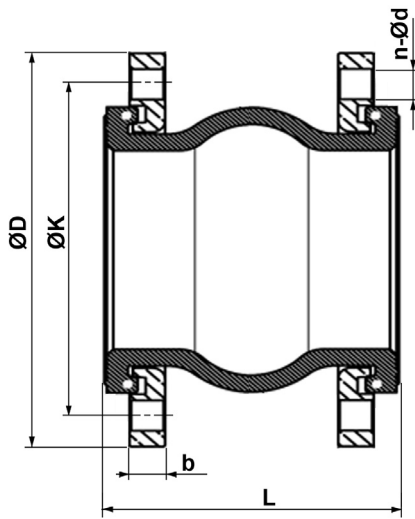

DN		L	øK	n x ød	øD	b	Lc	Le	Li	A°	Weight (kg)
mm	inch										
32	1"1/4	130	100	4 x ø18	140	16	10	6	10	25	3.2
40	1"1/2	130	110	4 x ø18	150	16	10	6	10	25	3.7
50	2"	130	125	4 x ø18	165	16	10	6	10	25	4.4
65	2"1/2	130	145	8 x ø18	185	18	15	8	12	25	6
80	3"	130	160	8 x ø18	200	18	15	8	12	25	6.3
100	4"	130	180	8 x ø18	220	18	20	12	16	15	7.3
125	5"	130	210	8 x ø18	250	20	20	12	16	15	9.7
150	6"	130	240	8 x ø22	285	22	20	12	16	15	13.3
200	8"	130	295	12 x ø22	340	22	20	12	16	15	16.75
250	10"	130	350	12 x ø26	405	24	30	14	25	8	23.2
300	12"	130	400	12 x ø26	460	26	30	14	25	8	31.9
350	14"	255	460	16 x ø23	505	28	30	14	25	8	39.6
400	16"	255	515	16 x ø27	565	30	30	14	25	8	46.8
450	18"	265	565	20 x ø27	615	30	30	14	25	8	53.5
500	20"	265	620	20 x ø27	670	32	30	14	25	8	64.7
600	24"	265	725	20 x ø29	780	36	30	14	25	8	79.8

WORKING CONDITIONS

Working temperature, °C	40	50	60	70	80	90	100
Working pressure, bar	16	12.4	10	7.5	6.5	5.2	4.1

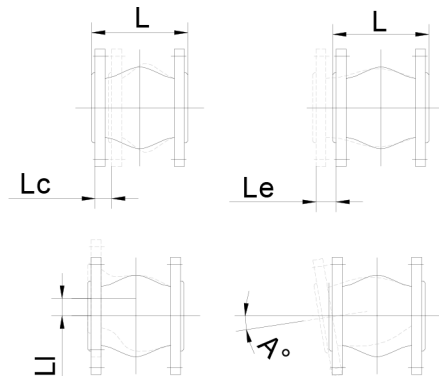
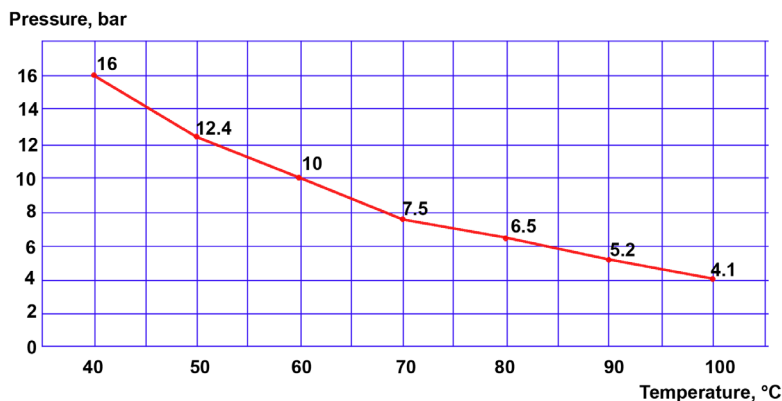

Lc : Axial compression
Le : Axial elongation
Li : Lateral movement
A° : Angle movement

Tecofi France

83 rue Marcel Mérieux - 69960 Corbas
Tél. +33 (0)4 72 79 05 79 - Fax. +33 (0)4 78 90 19 19
E-mail : sales@tecofi.fr - www.tecofi.fr

