

WAFER AXIAL CHECK VALVE

TECHNICAL PASSPORT

WAFER AXIAL CHECK VALVE STAINLESS STEEL BODY

CA 6461

APPLICATION

Axial non-return check valve.

Area of use: pneumatic installations, heating, chemical industry, water supply, irrigation, thermal stations, high pressure, etc.



Fluids: hot or cold clear water, various uncharged liquids, corrosive chemical products, steam, gas, etc.



GENERAL CHARACTERISTICS

- Range:** from DN15 to DN100.
- Non-return check valve with one centering ring (except DN100 : three rings).
- Mounting between flanges according to several standards.
- Reduced face to face dimension, minimum pressure drop.
- Prevents water hammer by closing when the pressure is canceled.
- Tightness guaranteed thanks to perfect contact between the disc and the body.
- Stainless steel return spring ensuring mounting in all positions.
- Mounting in vertical position with ascending fluid in the case of using check valve without spring.
- Simple installation and use.

STANDARDS

Design	Fabrication according to EN 16767 Conforme aux exigences de la Directive Européenne 2014/68/UE
Connection	Between flanges drilled according EN 1092-2 and DIN 2501/1 : ISO PN10/16/25/40. Connection also possible between DIN, UNE (PN6, PN10, PN16, PN25 and PN40 ASA (ANSI) (PS1150 and 300).
Face to face	According to EN-558 serie 49
Tests	Pressure test according to standards EN12266-1 and ISO 5208: Body : PS x 1.5 bar Seat : PS x 1.1bar

PRODUCT APPROVALS



Tecofi France

83 rue Marcel Mérieux - 69960 Corbas
Tél. +33 (0)4 72 79 05 79 - Fax. +33 (0)4 78 90 19 19
E-mail : sales@tecofi.fr - www.tecofi.fr



WAFER AXIAL CHECK VALVE

TECHNICAL PASSPORT

CA 6461

CONSTRUCTION

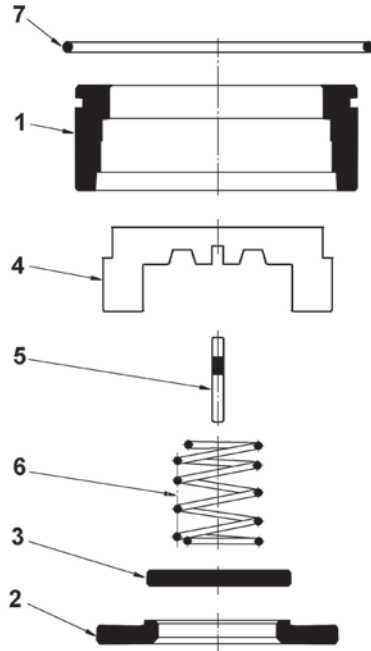

Pos.	Description	Material
1	Body	Stainless steel EN-1.4401
2	Seat	Stainless steel EN-1.4401
3	Disc	Stainless steel EN-1.4401
4	Spring press	Stainless steel EN-1.4401
5	Stem	Stainless steel EN-1.4401
6	Spring	Stainless steel EN-1.4571
7	Centering ring	Stainless steel EN-1.4310

DIMENSIONS

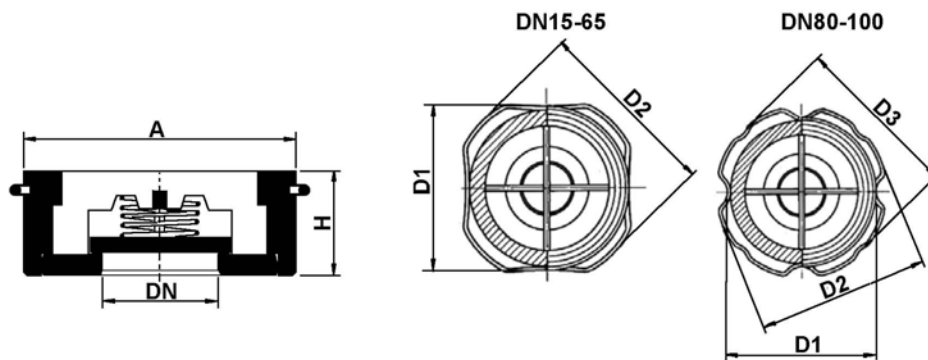

DN		H	A	D1	D2	D3	Weight (kg)
mm	inch						
15	1/2"	17	44.5	44.5	52	-	0.11
20	3/8"	20	54.5	54.5	65.5	-	0.21
25	1"	22	64.5	64.5	72	-	0.30
32	1 1/4"	28	75	75	83	-	0.51
40	1 1/2"	32	84	84	93.5	-	0.75
50	2"	40		97.5		97.5	1.05
65	2 1/2"	46	117	117	127	-	1.92
80	3"	50	133	133	154	142.5	2.70
100	4"	60	153	153	168.5	162.5	3.90

Tecofi France

83 rue Marcel Mérieux - 69960 Corbas
 Tél. +33 (0)4 72 79 05 79 - Fax. +33 (0)4 78 90 19 19
 E-mail : sales@tecofi.fr - www.tecofi.fr

ISO 9001
 ISO 14001
 BUREAU VERITAS
 Certification



WAFER AXIAL CHECK VALVE

TECHNICAL PASSPORT

CA 6461

WORKING CONDITIONS

Maximum working pressure : 40 bar (-60°C / +120°C)
 34 bar (-60°C / +200°C)
 32 bar (-60°C / +300°C)
 29 bar (-60°C / +400°C)

Warning! For operating temperatures above 300°C, it is imperative to use the check valve without spring, therefore only for a vertical position with ascending fluid.

CRACKING PRESSURE (mbar)

DN		Mounting direction				Flow factor	
		Without spring	With spring			Kv	Cv
mm	inch	Vertical ascending	Vertical ascending	Horizontal	Vertical descending		
15	1/2"	2.51	22.0	20.50	17.00	3.96	15.80
20	3/8"	2.38	21.90	20.50	17.10	7.20	32.50
25	1"	1.96	21.50	20.50	17.50	10.80	49.20
32	1"1/4	3.70	23.20	20.50	15.80	18.00	80.00
40	1"1/2	4.00	23.50	20.50	15.50	23.00	105.00
50	2"	4.11	23.60	20.50	15.40	36.00	166.00
65	2"1/2	4.95	24.40	20.50	14.60	60.00	306.00
80	3"	5.64	25.10	20.50	13.90	79.00	382.00
100	4"	6.81	26.30	20.50	12.70	118.00	540.00

HEAD LOSS DIAGRAMM

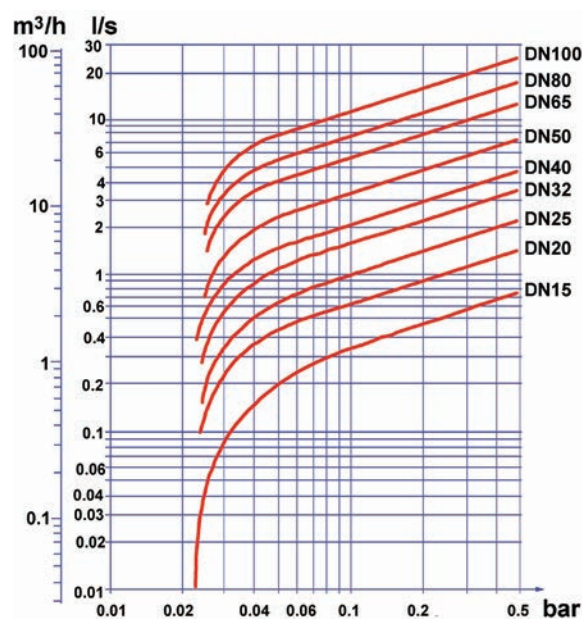

Tecofi France

83 rue Marcel Mérieux - 69960 Corbas
 Tél. +33 (0)4 72 79 05 79 - Fax. +33 (0)4 78 90 19 19
 E-mail : sales@tecofi.fr - www.tecofi.fr

