

NON RETURN AXIAL CHECK VALVE

TECHNICAL PASSPORT

AXIAL CHECK VALVE - STAINLESS STEEL BODY WAFER TYPE

CA 6460

APPLICATION

Protection of installations against reverse flow.

-Area of use: Chemical, harmaceutical or petro-chemical industries, corrosive products, high pressure, high temperature, thermal fluid, hydraulic networks, etc.



-Fluids: water, gaz, compressed air, steam, chemicals.



GENERAL CHARACTERISTICS

- Range : from DN 15 to DN200.

Non-return check valve.in stainless steel with multi-position disc. metal/metal sealing, reduced face to face.

Excellent hydraulic results. High performance in pressure and temperature.

Mounting between flanges PN10/16/25/40 and PN20 from DN15 to DN100.

For mounting between flanges PN10/16 in DN100 only 4 bolts will be used.

For mounting between flanges PN20 in DN25, DN32 en DN40, 4 M12 bolts will be used. Mounting can be carried out in a horizontal or verical position.

Low pressure losses. Does not cause water hammer

STANDARDS

Connection	Mounting between flanges EN 1092-2 et DIN 2501/1 : ISO PN10/16/25/40 and PN20
Tests	Hydraulic tests in accordance with EN12266-1, DIN 3230, BS 5154 and ISO 5208: - Body : 1.5xPS bar - Seat : 1.1xPS bar

PRODUCT APPROVALS



Tecofi France

83 rue Marcel Mérieux - 69960 Corbas
Tél. +33 (0)4 72 79 05 79 - Fax. +33 (0)4 78 90 19 19
E-mail : sales@tecofi.fr - www.tecofi.fr



NON RETURN AXIAL CHECK VALVE

TECHNICAL PASSPORT

CA 6460

CONSTRUCTION

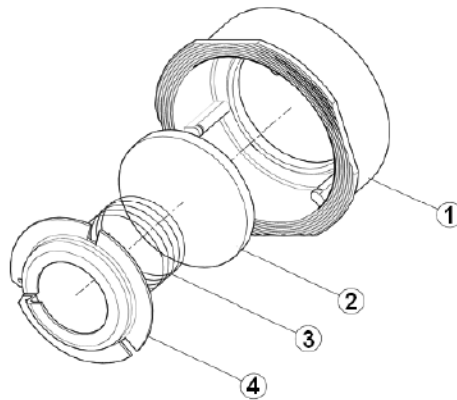

Pos.	Description	Material
1	Body	Stainless steel ASTM A351 CF8M
2	Disc	Stainless steel ASTM A240-316
3	Spring	Stainless steel AISI 316
4	Spring holder	Stainless steel ASTM A240-316

DIMENSIONS

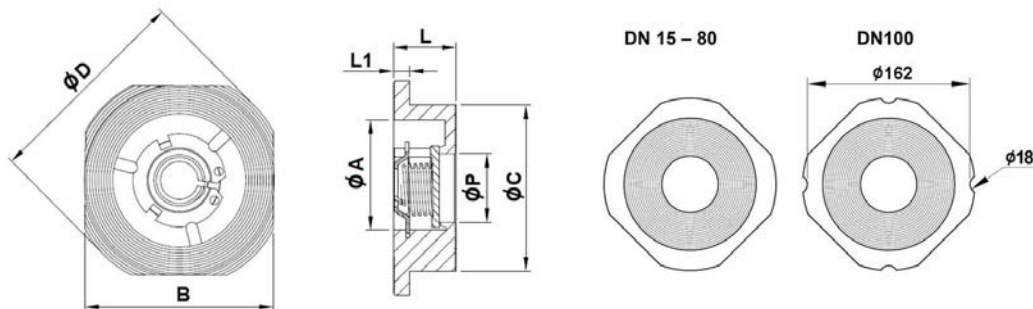

DN		Ø A	B	Ø C	Ø D	L	L1	Ø P	Weight (kg)
mm	inch								
15	1/2"	34	44.6	40.5	54	16	3.5	12.5	0.1
20	3/4"	39	54	47	62	19	3.5	20	0.2
25	1"	46	65	56	73	22	4	25	0.3
32	1 1/4"	60	78	70	83	28	5	32	0.5
40	1 1/2"	70	88	80	93	31.5	5	38	0.6
50	2"	79	101.6	90	107	40	5	49	0.9
65	2 1/2"	101	120.4	113	126.5	46	5.5	64	1.4
80	3"	109	133	123	141.2	49	5.5	78	2
100	4"	134	164	150	171.4	60	6.5	98	3

Tecofi France

83 rue Marcel Mérieux - 69960 Corbas
 Tél. +33 (0)4 72 79 05 79 - Fax. +33 (0)4 78 90 19 19
 E-mail : sales@tecofi.fr - www.tecofi.fr



NON RETURN AXIAL CHECK VALVE

TECHNICAL PASSPORT

CA 6460

DIMENSIONS

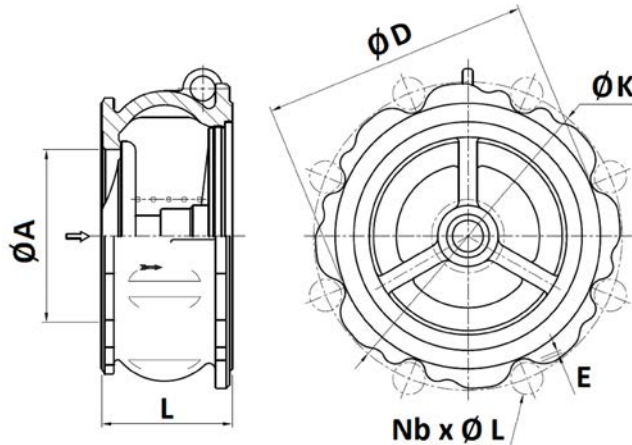

DN		L	Ø A	Ø D	Ø K	NB x L	E	Kvs (m³/h)	Weight (kg)
mm	inch								
125	5"	90	120	186	220	8 x 26	3	228	7.34
150	6"	106	140	216	250	8 x 26	2.7	809	13.4
200	8"	140	184	267	320	12 x 30	10	647	24.2

WORKING CONDITIONS

Maximum working pressure : 40 bar
(14 bar maximum for steam)
Maximum working temperature : -20°C /+ 200°C

PRESSION / TEMPERATURE DIAGRAMM DN15-100

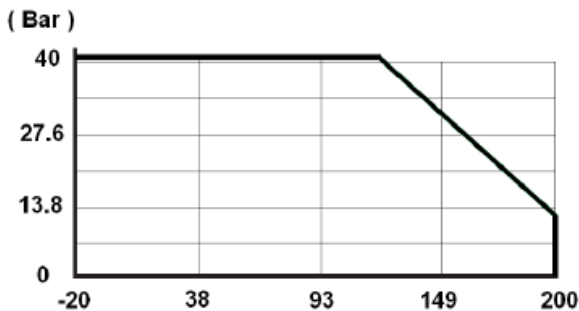

PRESSION / TEMPERATURE CHART DN125-200

Pressure (bar)	39.2	38	33.3	30.4	28.2
Temperature (°C)	-10	50	100	150	200

Tecofi France

83 rue Marcel Mérieux - 69960 Corbas
Tél. +33 (0)4 72 79 05 79 - Fax. +33 (0)4 78 90 19 19
E-mail : sales@tecofi.fr - www.tecofi.fr



NON RETURN AXIAL CHECK VALVE

TECHNICAL PASSPORT

CA 6460

CRACKING PRESSURE (mbar)

DN	15	20	25	32	40	50	65	80	100	125	150	200
Horizontal position	23	23	23	24	25	25	25	26	27	51	50	49
Vertical ascending position	25	25	25	27	29	29	31	32	33	60	60	62

FLOW FACTOR KVS (m³/h)

DN	15	20	25	32	40	50	65	80	100	125	150	200
KVS (m³/h)	2.1	5.76	9.6	14.5	21.9	24.2	57.1	64.97	90.2	228	809	647

HEAD LOSS DIAGRAMM

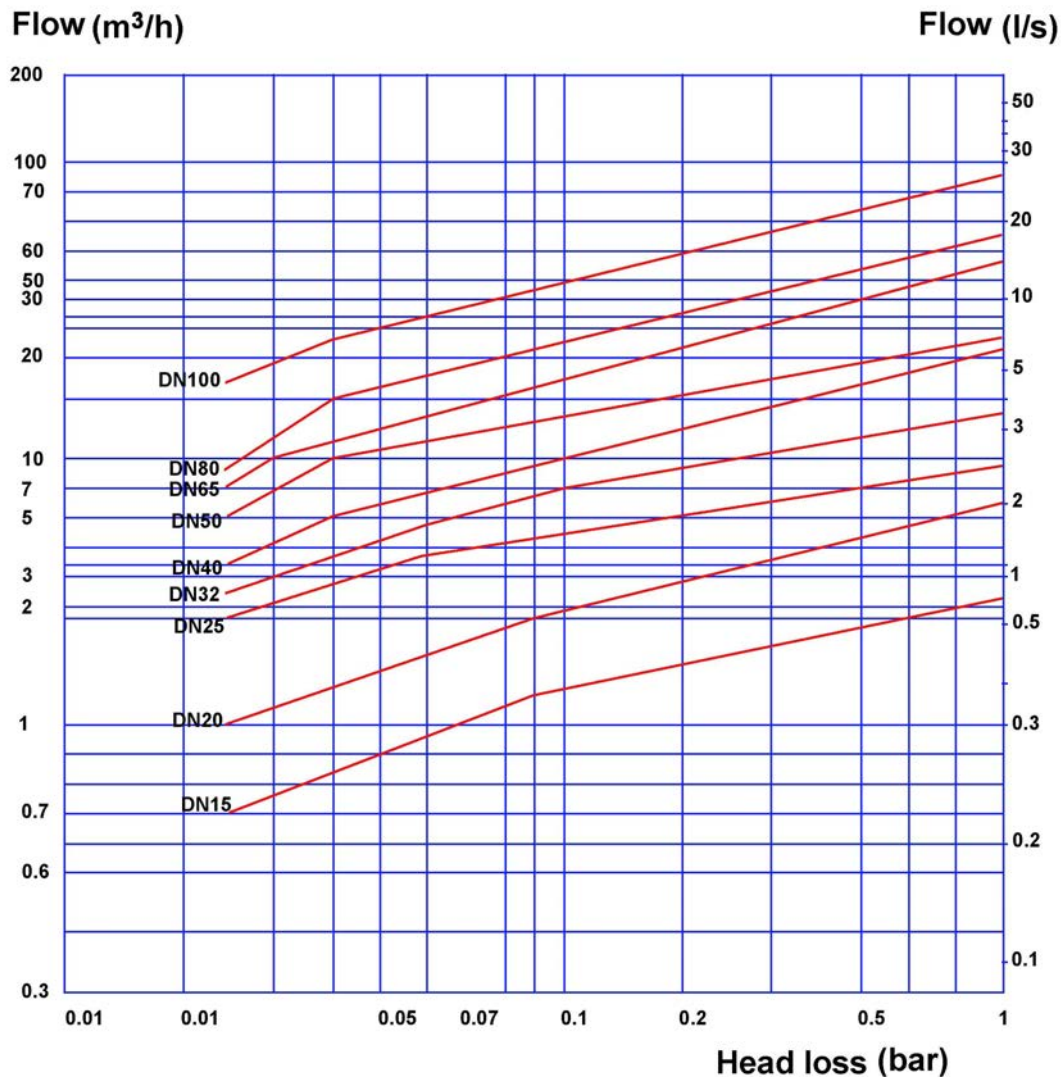

The photographs and technical art works are not contractual. The specifications of the presented products are open to modifications without previous advice

Tecofi France

83 rue Marcel Mérieux - 69960 Corbas
 Tél. +33 (0)4 72 79 05 79 - Fax. +33 (0)4 78 90 19 19
 E-mail : sales@tecofi.fr - www.tecofi.fr

