

Ref. : BS1152

Rev. :Initial

Date : 26/01/2015

Page : 1/1

# BRASS BALL VALVE FOR GAS

## BS 1152



**Tecofi**  
VALVE DESIGNER - FRANCE

### APPLICATION

General use : Gas MOP 5 class, · Natural Gas : obtained from petroleum ( methane ) and mix of propane / air, town gas, liquid gas : Propane and mix of propane / butane, installation in building NF E29-141

### GENERAL CHARACTERISTICS

Heavy type  
For steel pipe (possible for copper pipe but only with ISO 7 male conical fittings, no gasket fitting with tightness inside the worm thread)  
Full bore  
Anti blow-out stem  
Solid ball  
Double o ring NBR on stem  
Flat yellow color steel handle



### CONSTRUCTION

9	Handle cover	Plastic
8	Handle	Steel
7	Handle nut	Steel
6	Stem	Brass CW 614 N according to EN 12164
5	O ring	NBR 70 according to EN 549
4	Nipple	Brass CW 617 N according to EN 12165
3	Seat	PTFE
2	Ball	Brass CW 617 N according to EN 12165 chromed
1	Body	Brass CW 617 N according to EN 12165
Pos.	Description	Material

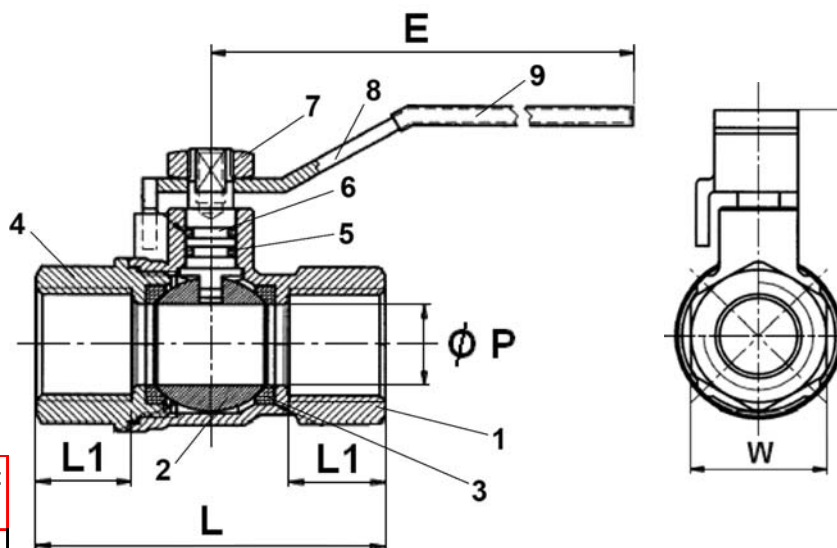

### DIMENSIONS

DN		L	L1	H	E	W	ØP	Weight (kg)
mm	inch							
15	1/2"	62	17	44	90	26	15	0,236
20	3/4"	70	18,5	52,5	110	32	20	0,378
25	1"	82	21	57	110	40	25	0,62
32	1"1/4"	98	22	66	115	49	32	1,034
40	1"1/2"	109	22	73,5	115	55	40	1,38
50	2"	125	26	84	150	68	47	2,113

### WORKING CONDITIONS

Maximum working temperature : - 5 °C / +60°C

Maximum working pressure: 5 bar

### STANDARDS

Fabrication according to ISO 9001 : 2008  
DIRECTIVE 2014/68/UE : Products excluded from directive ( Article 1, § 3.6 )  
BG Technologies agreement according to **EN 331 :1998**  
Designing according to **90/396/EEC** for gas families 1, 2 and 3  
Threaded female BSP cylindrical according to **ISO 228-1**

### HEAD LOSS GRAPH

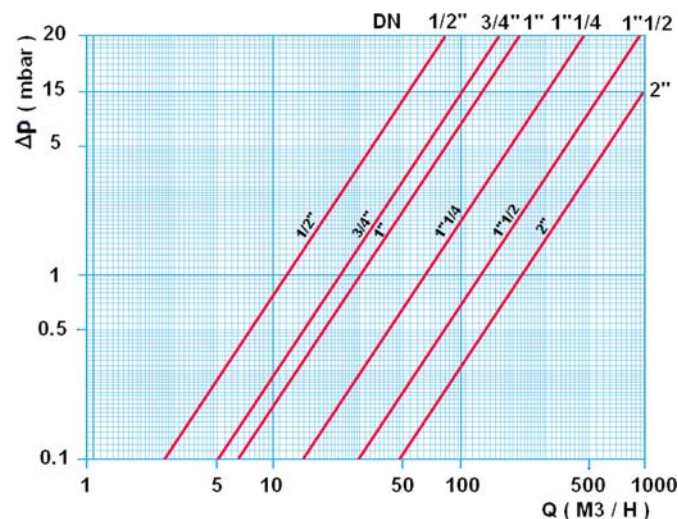

**TECOFI France** - 83, Rue Marcel Mérier 69960 Corbas - FRANCE  
Tél. +33 (0) 4 72 79 05 79 - Fax +33 (0) 4 78 90 19 19 / +33 (0) 4 72 79 05 70  
Adresses e-mail : sales@tecofi.fr ; tecofi@tecofi.fr / Site web : [www.tecofi.fr](http://www.tecofi.fr)