

Ref. : ADTUNI

Rev. : D

Date : 30/10/2018

Page : 1/1

FLANGE ADAPTOR

ADTUNI



APPLICATION

General use: for joining pipes of different rigid materials, such as cast iron, stainless steel, PVC etc...

GENERAL CHARACTERISTICS

Range from Ø60 to Ø904.
Epoxy coated body (250 microns thickness) in ductile iron for DN50-800 and steel for DN900.
GEOMET coated bolts and nuts.
Maximum deflection angle: 6°

CONSTRUCTION

4	Gasket	EPDM
3	Bolt	Zinc plated steel 6.8
2	Counter-flange	Ductile iron GGG50
1	Flange	Ductile iron GGG50
Pos.	Description	Material



Do not assemble on PN10 flange with threaded holes

DIMENSIONS

DN	Ø	L1	L2
50	60-80	145	190
60-65	70-90	145	200
80	88-113	150	223
100	107-132	125	242
125	133-159	140	269
150	159-184	175	296
150/175	165-195	183	317
200-A	194-226	183	354
200	216-246	183	368
250-A	244-276	158	400
250	266-297	158	419
300	315-345	158	469
300-A	345-375	200	499
350-A	353-387	158	529
350	375-405	200	529
400	400-435	209	565
400-A	435-470	298	600
400-B	470-505	304	645
450	475-510	298	640
500-A	499-534	208	665
500	530-565	208	695
500-B	575-610	208	695
600	610-645	208	775
600-A	645-680	298	810
700	710-745	220	910
700-A	758-793	306	964
800	810-845	225	1025
800-A	867-904	306	1075
900	913-949	290	1115

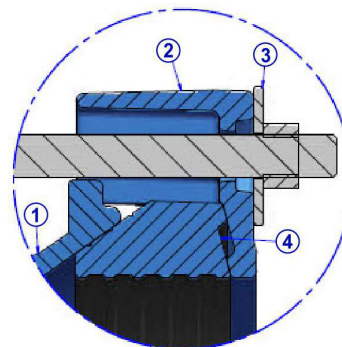
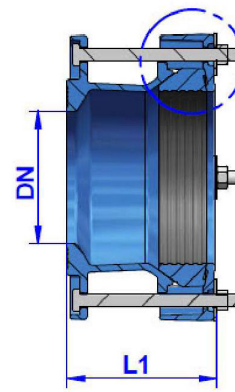
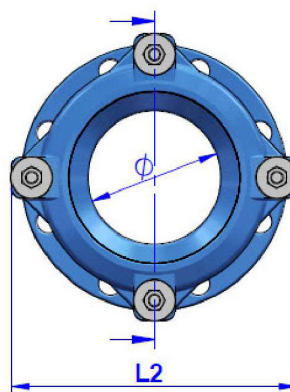

WORKING CONDITIONS

Maxi working pressure: 16 bar.

STANDARDS

Flange according to EN 1092-2 PN10/PN16 and ANSI (DN50-400)

TECOFI France - 83, Rue Marcel Mérieux 69960 Corbas - FRANCE
Tél. +33 (0) 4 72 79 05 79 - Fax +33 (0) 4 78 90 19 19 / +33 (0) 4 72 79 05 70
Adresses e-mail : sales@tecofi.fr ; tecofi@tecofi.fr / Site web : www.tecofi.fr